

kg 37

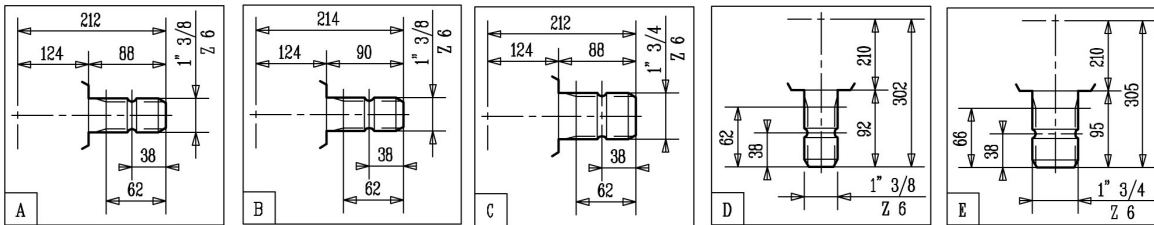



LT. 2,5
SAE.90EP

Shaft Profiles - Tipi di Albero

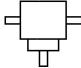
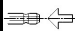

T-279A

Technical Data - Dati Tecnici

i	r.p.m.	HP	kW	daNm	InLbs	X	Y	Z					L			 comer industries	
									5	6	-	-		-	0		Z
1 : 1	540	100	73,6	126	11159	C	C	E	5	6	-	-	-	0	Z	-	279.201
1 : 1	540	100	73,6	126	11159	-	A	D	1	2	-	-	-	0	Z	-	279.202
1 : 1,35	540	100	73,6	93	8272	A	A	D	33	34	-	-	-	0	Z	-	279.016
1 : 1,35	540	100	73,6	93	8272	-	B	D	21	22	-	-	-	0	Y	-	279.022
1 : 1,5	540	90	66,2	76	6695	-	B	D	21	22	-	-	-	0	Y	-	279.014
1 : 1,5	540	90	66,2	76	6695	A	A	D	33	34	-	-	-	0	Z	-	279.018
1,35 : 1	540	90	66,2	153	13559	-	B	D	1	2	-	-	-	0	Z	-	279.022
1,5 : 1	540	80	58,9	151	13399	-	B	D	1	2	-	-	-	0	Z	-	279.014
1,5 : 1	540	80	58,9	151	13399	A	A	D	5	6	-	-	-	0	Z	-	279.015