

kg 116,8



LT. 0

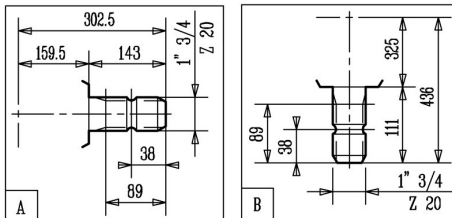

SAE.90EP

### Shaft Profiles - Tipi di Albero

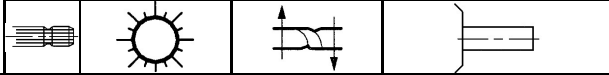
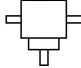
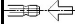

# T-332A

*Technical Data - Dati Tecnici*

																	
i	r.p.m.	HP	kW	daNm	InLbs	X	Y	Z				L					
1,94 : 1	540	250	184	611	54137	A	A	B	5	6	-	-	-	0	Z	-	332.000
3 : 1	540	170	125	643	56926	A	A	B	5	6	-	-	-	0	Z	-	332.003
4,25 : 1	540	105	77,3	562	49815	A	A	B	5	6	-	-	-	0	Z	-	333.002